

신기술신개발 대용량 드라이 스크류

Screw Type DRY Vacuum Pumps

개요 Features

- 오일과 물이 없는 건식윤전작동
- SINGLE STAGE/SIMPLE DESIGN
- 오일 및 물등 사용치 않음
- 필연적 가스의 통과가 필요 가스의 신속한 배출
- 스크류타입의 ROTOR를 사용함에 따라 높은 제척효율

시스템의 필요성 Advantages to Users

- 깨끗한 진공을 생성
- 동력 절약으로 인한 UTILITY 비용 절감
- 독성, 부식성 그리고 증축성가스로부터 펌프를 보호할 코팅막 적용가능
- 트출온도가 매우 감소
- CAPACITY 증가 및 진공도 상승
- 작고 COMPACT한 설계로 설치면적이 적다.
- C-FLANGE TYPE으로 설치가 간단하고 소음을 줄일 수 있으며 SHAFT ALIGNMENT를 맞출 필요가 없다.

특징과 장점 Features and Benefits

- 저렴한 유지보수 및 운전비용
- 고품질의 립셀 사용
- 정밀타입기어 사용
- 공정내 발생가능한 오염 물질이 없는 구조
- 저에너지 소모 및 저소음 실현
- 폐수 및 오염물 처리 비용이 없음

적용분야 Applications

화학공업, 식품공업, 합성, 의약품

증발 농축, 건조, 동결건조, 증류, 분자증류, 탈취, 탈포, 탈수, 탈가스, 포장, 성형, 흡착, 항원, 살균, 조습, 증축함, 분체수송, 액체수송, 식품첨가제, 기소제, 계면활성제

CHEMICAL & FOOD IND., POLYMER, MEDICINE, ETC.

Evaporating Condensation, Drying, Freeze Drying, Distilling, Molecular Distillation, Deodorization, Deforming, Dehydration, Degassing, Packing, Forming, Absorbing, Impregnation, Conditioning Esterification, Polymerization & Esterification, Pneumatic Conveying, Liquid Transfer by Vacuum, Food Additive, Pesticizer, surfactant

- Oil and water do not dry-run operation
- SINGLE STAGE / SIMPLE DESIGN
- Not in use oil and water
- Pump my gas, the rapid passage of the shorter gas impellers
- As you use the screw-type ROTOR high volume with efficiency

- Create a clean vacuum
- UTILITY power savings due to reduced
- Toxic, corrosive and condensable gases can be applied coating to protect the pump from
- Greatly reduced, the discharge temperature
- CAPACITY growth and rise in vacuum
- COMPACT small one, small footprint design
- C-FLANGE TYPE installation is simple and can reduce noise
- SHAFT ALIGNMENT do not need to match

- Low maintenance and operating costs
- Use high-quality ripcell
- Precision Gear used one class
- Potential contaminants in the process structure without
- Low energy consumption and low noise realization
- No waste and contamination treatment costs

Basic construction

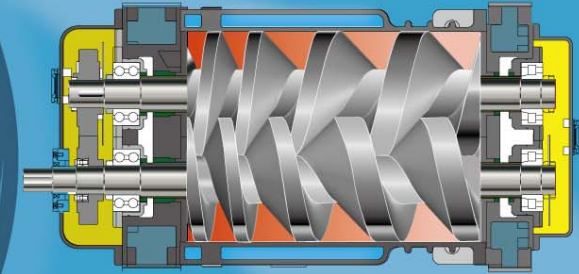

더 빠른 펌핑속도와 더 높은 진공도를 제공
 · 광범위한 산업영역에서 입증된 신뢰성
 · 화학, 플라스틱, 반도체, 전자, 식품가공 등
 · 낮은 소음
 · 내부식성 및 경도를 향상시키기 위하여 각종 코팅막 적용 가능

A faster pumping speed and a higher degree of vacuum to provide
 · Proven reliability in a wide range of industrial areas
 · Chemicals, plastics, semiconductor, electronics, food processing, etc.
 · Low noise
 · In order to improve the corrosion resistance and hardness Coating can be applied to various

Screw Type DRY Vacuum Pumps

신기술신개발 대용량 드라이 스크류

개요 Features

- 오일과 물이 없는 건식운전작동
- SINGLE STAGE/SIMPLE DESIGN
- 오일 및 물을 사용하지 않음
- 펌프내 가스의 통로가 짧아 가스의 신속한 배출
- 스크류타입의 ROTOR를 사용함에 따라 높은 제적효율

- Oil and water do not dry-run operation
- SINGLE STAGE / SIMPLE DESIGN
- Not in use, oil and water.
- Pump my gas, the rapid passage of the shorter gas emissions
- As you use the screw-type ROTOR high volumetric efficiency

시스템의 필요성 Advantages to Users

- 깨끗한 진공을 생성
- 동력 절감으로 인한 UTILITY 비용 절감
- 독성 부식성 그리고 응축성가스로부터 펌프를 보호할 코팅막 적용가능
- 토출온도가 매우 감소
- CAPACITY 증가 및 진공도 상승
- 작고 COMPACT한 설계로 설치면적이 적다.
- C-FLANGE TYPE으로 설치가 간단하고 소음을 줄일 수 있으며 SHAFT ALIGNMENT를 맞출 필요가 없다.

- Create a clean vacuum
- UTILITY, power savings due to reduced
- Toxic, corrosive and condensable gases can be applied coating to protect the pump from
- Greatly reduced, the discharge temperature
- CAPACITY growth and rise in vacuum
- COMPACT small one, small footprint design
- C-FLANGE TYPE installation is simple and can reduce noise
- SHAFT ALIGNMENT do not need to match.

특징과 장점 Features and Benefits

- 저렴한 유지보수 및 운전비용
- 고품질의 펌실 사용
- 정밀/납기어 사용
- 공정내 발생가능한 오염 물질이 없는 구조
- 저에너지 소모 및 저소음 실현
- 폐수 및 오염물 처리 비용이 없음

- Low maintenance and operating costs
- Use high-quality lips
- Precision Gear used one class
- Potential contaminants in the process structure without
- Low energy consumption and low noise realization
- No waste and contamination treatment costs



단면도(Section Drawing)

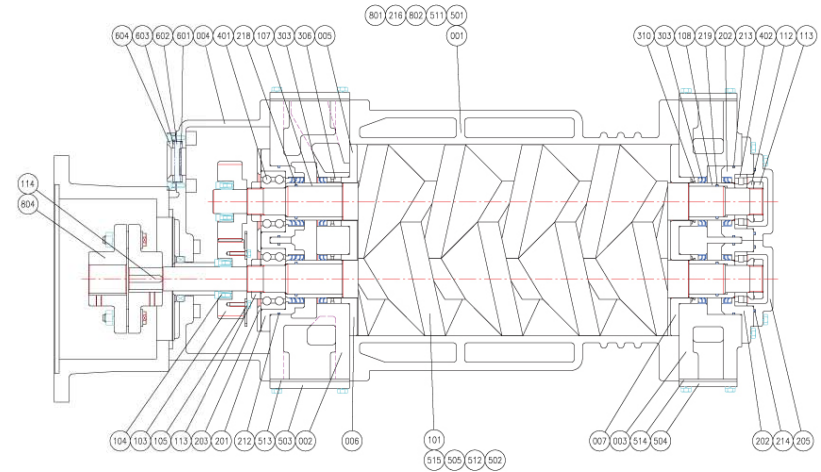

NO.	PARTS NAME	QTY	NO.	PARTS NAME	QTY	NO.	PARTS NAME	QTY
108	END SLEEVE	2	219	O-RING (END SLEEVE)	2	513	FRONT COOLING COVER	2
107	FRONT SLEEVE	2	218	O-RING (FRONT SLEEVE)	2	512	CASING DOWN COOLING COVER	1
105	OIL SPLASHER	1	216	O-RING	3	511	CASING TOP COOLING COVER	1
104	POWER LOCK	2	214	O-RING (END BEARING COVER)	2	505	GEAR DOWN COOLING COVER	1
103	TIMMING GEAR	1SET	213	O-RING (END BEARING HOLDER)	2	504	END COOLING COVER	2
101	SCREW	1SET	212	O-RING (FRONT BEARING HOLDER)	2	503	FRONT COOLING COVER	2
007	END GUARDED PLATE	2	205	BEARING COVER	2	502	CASING DOWN COOLING COVER	1
006	FRONT GUARDED PLATE	1	203	BEARING STOPPER	2	501	CASING TOP COOLING COVER	1
005	OPENING FRONT GUARDED PLATE	1	202	END BEARING HOLDER	2	402	ROLLER BEARING	2
004	GEAR COVER	1	201	FRONT BEARING HOLDER	2	401	DOUBLE BALL BEARING	2
003	END SIDE PLATE	1	114	PARALLEL KEY	1	310	END TEFLON PACKING	2
002	FRONT SIDE PLATE	1	113	LOCK NUT	2	306	FRONT TEFLON PACKING	2
001	BODY CASING	1	112	BEARING WASHER	2	303	ZLIP SEAL	10
601	OIL SIGHT LEVEL GASKET	1	602	OIL SIGHT GLASS	1	801	AIR VENT	1
515	GEAR DOWN COOLING COVER	1	803	DOUBLE MECH. SEAL	1	604	OIL SIGHT COVER	1
514	END COOLING COVER	2	802	I-BOLT	2	603	OIL SIGHT GASKET	1

General Technical

MODELS	UNIT	SDP100	SDP200	SDP300	SDP400
DISPLACEMENT (50hz/60hz)	m ³ /hr	100 / 120	170 / 220	250 / 300	350 / 420
ULTIMATE PRESSURE (50hz/60hz)	Torr	0,5 / 0,1	0,1 / 0,05	0,1 / 0,05	0,1 / 0,05
POWER (50hz/60hz)	KW	3,7 / 5,5	5,5 / 7,5	7,5 / 11	11 / 15
REVOLUTION FOR PUMP 50hz/60hz	RPM	2900 / 3600	2900 / 3600	2900 / 3600	2900 / 3600
SUCTION PORT SIZE	mm	40	50	50	65
DISCHARGE PORT SIZE	mm	40	40	40	50
GEAR OIL	L	1,5	1,5	2,6	2,6
COOLING WATER	L/min	8	10	12	15

(Performance Curve)

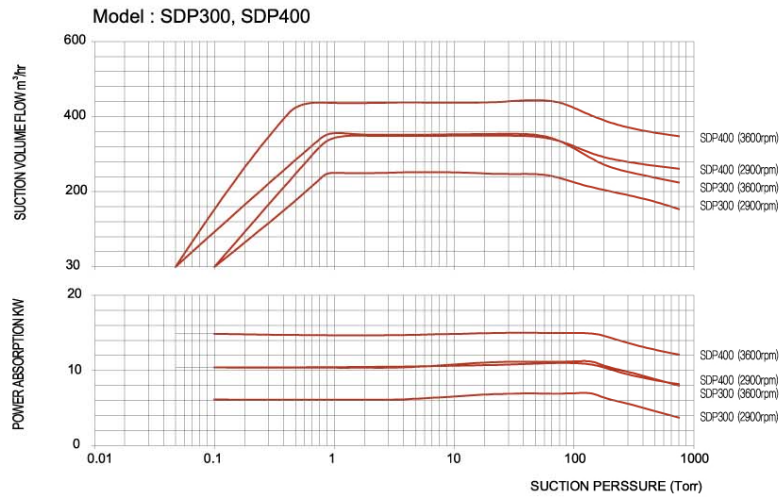
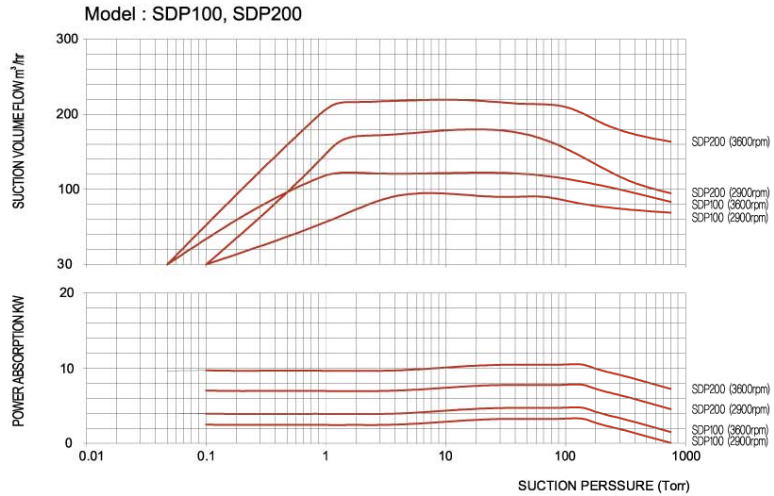

The operational data are applicable under the following conditions :

- Pumping medium —dryair 20°C
- cooling water —water 15~25°C (less than ΔT 3°C)

Compression pressure 760Torr (atmospheric pressure)
 The suction volume flow is applied to the suction pressure
 Tolerance of the suction capacity is 10%

(Dimensions)

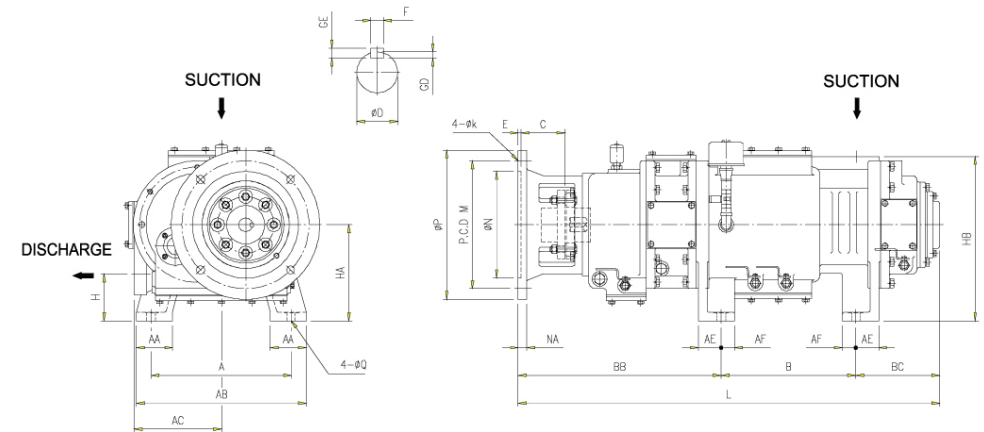

MODELS	A	AA	AB	AC	AE	AF	C	B	BB	BC	ØD	E	F	GD	GE	H	HA	HB	øk	L
SDP100	290	80	350	168	57,5	32,5	83	295	424,5	179,5	28	5,5	8	4	7	90	190	340	15	909
SDP200	290	80	350	168	52,5	31,5	83	295	424,5	179,5	28	5,5	8	4	7	90	190	340	15	899
SDP300	330	85	400	205	53,5	31,5	104	326	478,5	191,5	32	6	10	5	8	110	225	385	19	996
SDP400	330	85	400	205	53,5	31,5	114,5	370	497,5	196,5	32	6	10	5	8	110	225	385	19	1064

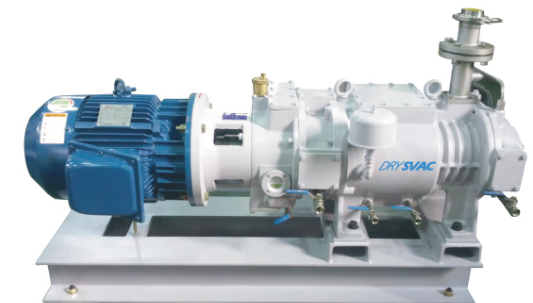

Screw Type DRY Vacuum Pumps

신기술신개발 대용량 드라이 스크류

개요 Features

- 오일과 물이 없는 건식운전작동
- SINGLE STAGE/SIMPLE DESIGN
- 오일 및 물을 사용하지 않음
- 펌프내 가스의 통로가 짧아 가스의 신속한 배출
- 스크류타입의 ROTOR를 사용함에 따라 높은 제적효율

시스템의 필요성

- 깨끗한 진공을 생성
- 동력 절감으로 인한 UTILITY 비용 절감
- 독성 부식성 그리고 응축성가스로부터 펌프를 보호할 코팅막 적용가능
- 토출온도가 매우 감소
- CAPACITY 증가 및 진공도 상승
- 작고 COMPACT한 설계로 설치면적이 작다.
- C-FLANGE TYPE으로 설치가 간단하고 소음을 줄일 수 있으며 SHAFT ALIGNMENT를 맞출 필요가 없다.

특징과 장점

- 저렴한 유지보수 및 운전비용
- 고품질의 펌플 사용
- 정밀납기어 사용
- 공정내 발생가능한 오염 물질이 없는 구조
- 저에너지 소모 및 저소음 실현
- 폐수 및 오염물 처리 비용이 없음

Oil and water do not dry-run operation

- SINGLE STAGE / SIMPLE DESIGN
- Not in use, oil and water.
- Pump my gas, the rapid passage of the shorter gas emissions
- As you use the screw-type ROTOR high volumetric efficiency

- Create a clean vacuum
- UTILITY, power savings due to reduced
- Toxic, corrosive and condensable gases can be applied coating to protect the pump from
- Greatly reduced, the discharge temperature
- CAPACITY growth and rise in vacuum
- COMPACT small one, small footprint design.
- C-FLANGE TYPE installation is simple and can reduce noise
- SHAFT ALIGNMENT do not need to match.

Features and Benefits

- lipseal
- Low maintenance and operating costs
- Use high-quality lipseal
- Precision Gear used one class
- Potential contaminants in the process structure without
- Low energy consumption and low noise realization
- No waste and contamination treatment costs

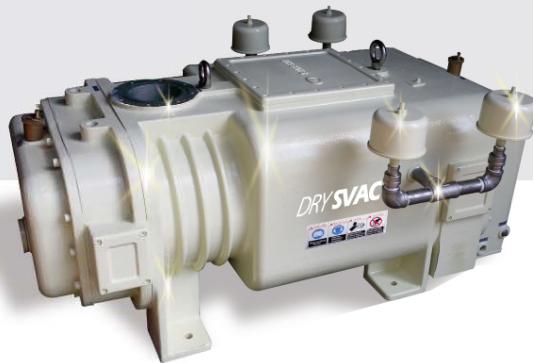

General Technical

MODELS	UNIT	SDP600	SDP800	SDP1500	SDP3000
DISPLACEMENT (50hz/60hz)	m3/hr	500 / 600	600 / 720	1200 / 1440	2250 / 2700
ULTIMATE PRESSURE (50hz/60hz)	Torr	0,1 / 0,05	0,1 / 0,05	0,2 / 0,05	0,2 / 0,05
POWER (50hz/60hz)	KW	15 / 18,5	18,5 / 22	30 / 37	45 / 55
REVOLUTION FOR PUMP 50hz/60hz	RPM	2900 / 3600	2900 / 3600	1450 / 1750	1450 / 1750
SUCTION PORT SIZE	mm	80	100	125	150
DISCHARGE PORT SIZE	mm	65	65	80	100
GEAR OIL	L	3,5	3,5	4,5	5,5
COOLING WATER	L/min	16	18	25	35

단면도(Section Drawing)

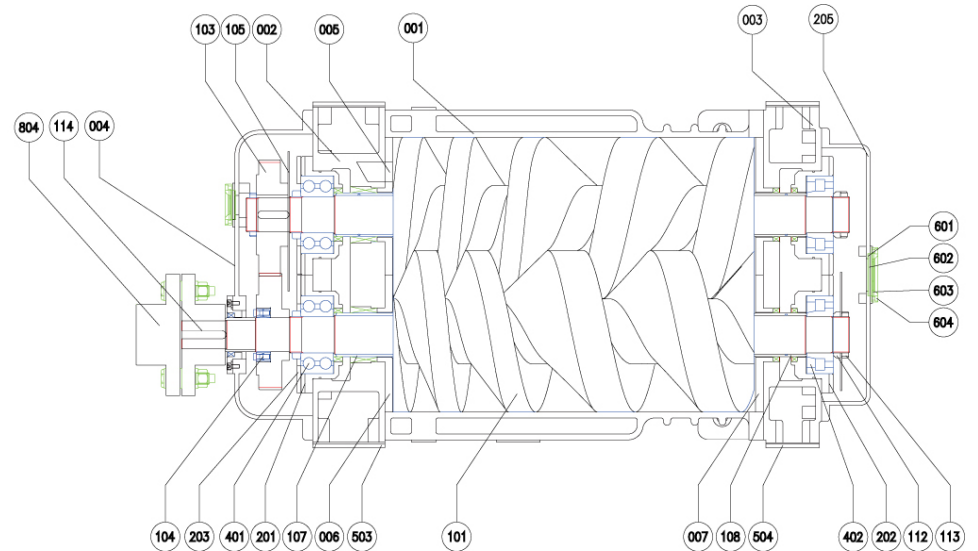

NO.	PARTS NAME	QTY	NO.	PARTS NAME	QTY	NO.	PARTS NAME	QTY
804	FLANGE COUPLING	1	402	ROLLER BEARING	2	104	POWER LOCK	2
802	I-BOLT	2	401	DOUBLE BALL BEARING	2	103	TIMMING GEAR	1SET
604	OIL SIGHT COVER	2	205	BEARING COVER	1	101	SCREW	1SET
603	OIL SIGHT LEVEL GASKET	2	203	BEARING STOPPER	2	007	END GUARDED PLATE	2
602	OIL SIGHT GLASS	2	202	END BEARING HOLDER	2	006	FRONT GUARDED PLATE	1
601	OIL SIGHT GASKET	2	201	FRONT BEARING HOLDER	2	005	OPENING FRONT GUARDED PLATE	1
505	GEAR DOWN COOLING COVER	1	114	PARALLEL KEY	2	004	GEAR COVER	1
504	END COOLING COVER	2	113	LOCK NUT	4	003	END SIDE PLATE	1
503	FRONT COOLING COVER	2	112	BEARING WASHER	2	002	FRONT SIDE PLATE	1
503	FRONT COOLING COVER	2	108	END SLEEVE	2	001	BODY CASING	1
502	CASING DOWN COOLING COVER	1	107	FRONT SLEEVE	2			
501	CASING TOP COOLING COVER	1	105	OIL SPLASHER	2			

성능곡선(Performance Curve)

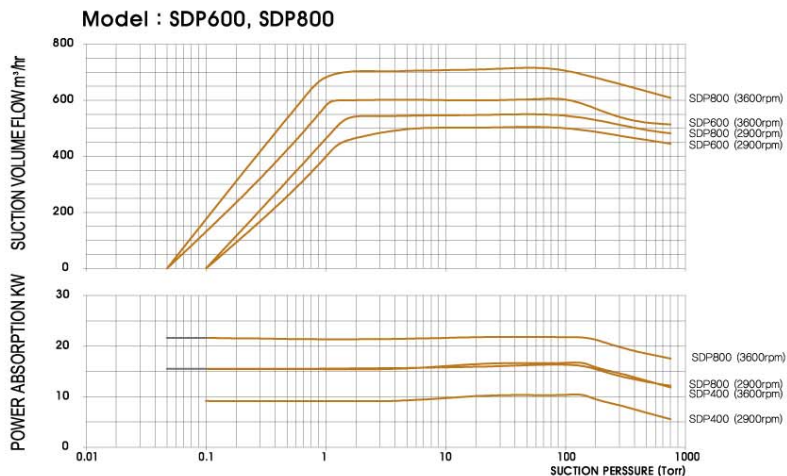

The operational data are applicable under the following conditions :
 ● Pumping medium —dryair 20°C
 ● cooling water —water 15~25°C (less than ΔT 3°C)
 Compression pressure 760Torr (atmospheric pressure)
 The suction volume flow is applied to the suction pressure
 Tolerance of the suction capacity is 10%

외형치수 (Dimensions)

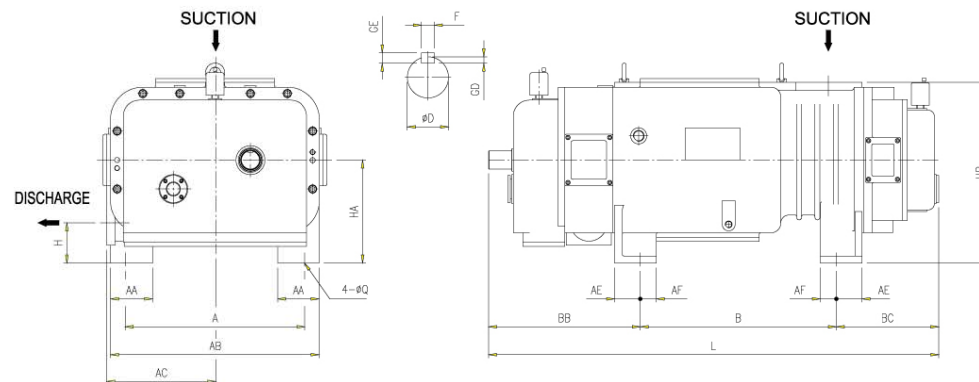

MODELS	A	AA	AB	AC	AE	AF	B	BB	BC	ØD	F	GD	GE	H	HA	HB	L	ØQ	WEIGHT (KG)
SDP600	435	115	529	265	75	55	355	530	245	50	12	5	8	110	260	457	1130	19	570
SDP800	435	115	529	265	75	55	405	530	245	50	12	5	8	110	260	457	1180	19	600
SDP1500	560	130	650	339	80	50	610	471,5	318,5	58	16	6	10	125	320	561	1400	23	1280
SDP3000	600	150	700	370	90	55	670	515	350	65	18	7	11	140	350	615	1535	27	1670



DRY SVAC

Oil and Water Free
Screw Type DRY Vacuum Pumps

DRY SVAC

삼신 드라이브

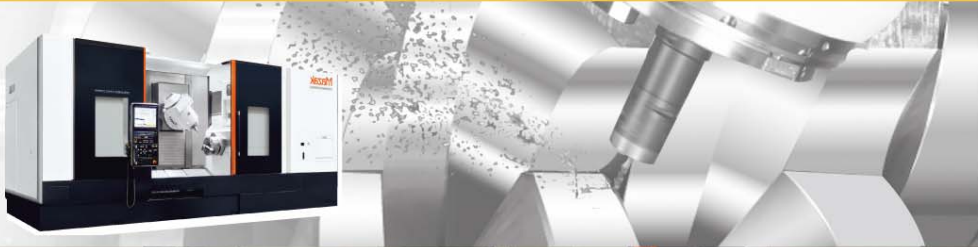

Screw Type
DRY
Vacuum Pumps



SINCE
1972

삼신진공주식회사

본사 공장 : 경기도 안양시 만안구 전마길 44번길 97(만양동)
Tel : 031-448-1341~2 Fax : 031-448-1342
화성공장 : 경기도 화성시 주석로 166-22

HEAD OFFICE / ANYANG :
37, Jeonpa-ro 44beon-gil, Manan-gu,
Anyang-si, Gyeonggi-Do, Korea
Tel : +82-31-448-1341~2
Fax : +82-31-448-1342
Email : sth30@chol.com

FACTORY / HWASEONG :
166-22 Juseok-ro, Hwaseong-si,
Gyeonggi-Do, Korea
TEL: +82-31-356-2352

